

MAZDA MX5 NB COOLING FAN

ASSEMBLY INSTRUCTIONS

B-MX5-NB

KIT CONTENTS

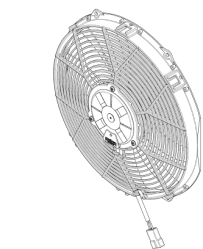

12" SLIMLINE SUCTION FAN
Part No. FAN0606
x1

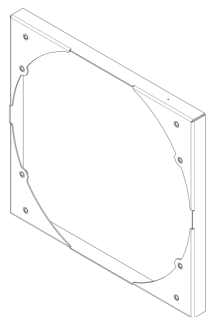

COOLING SHROUD
Part No. 130201
x1

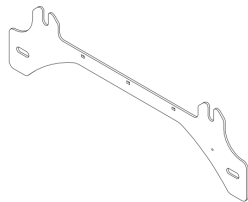

TOP BRACKET
Part No. 130200
x1

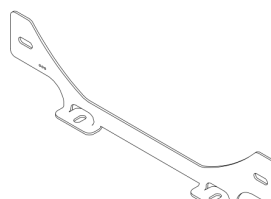

BOTTOM BRACKET
Part No. 130199
x1



M6 NYLOC NUT
Part No. 050011
x2

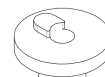

SPACER
Part No. 110143
x2



CABLE TIE 2.5mm
Part No. 110106
x3



M6x16mm FLANGE BOLT
Part No. 050099
x8



M6 WASHER FORM C
Part No. 050017
x4

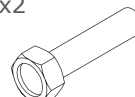

M6x30mm BOLT
Part No. 050120
x2



RUBBER EDGE
Part No. 080018
1.25m LENGTH

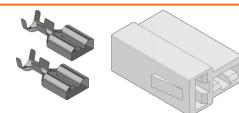

REVOTEC FAN MALE CONNECTOR KIT
Part No. RTB-2
x1 Kit

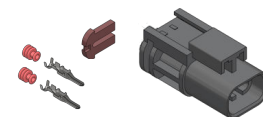

MX5 NB FAN OEM CONNECTOR KIT
Part No. 090109
x1 Kit

SIGNED OFF BY: _____ DATE: _____

FUSE SIZING

To prevent damage if a cooling fan gets blocked, the circuit powering the fan needs a time-delay type fuse with the correct amperage rating.
This installation uses 1x suction fan - part number FAN0606 (F27P-12E8004-41S).
The nominal running current is 7 amps.

STEP 1

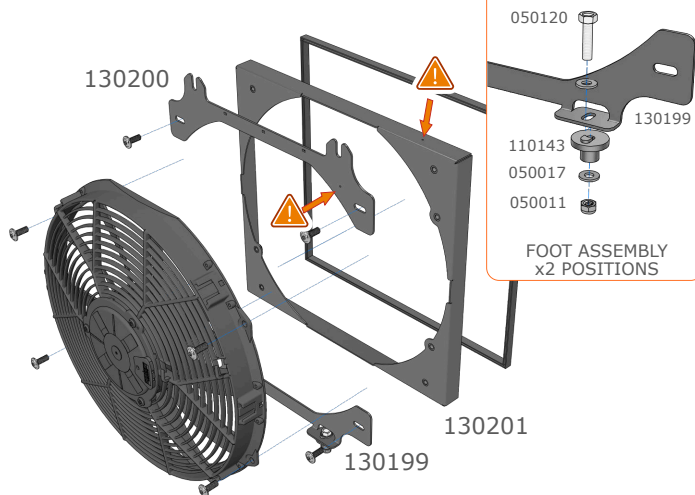

Assemble the fan kit as shown above. Note, the shroud has a hole pattern punched in the edge that corresponds to holes punched in the bracket. This is to help with alignment. The rubber edging should be cut to mitre at the corners and join without overlapping.

STEP 2

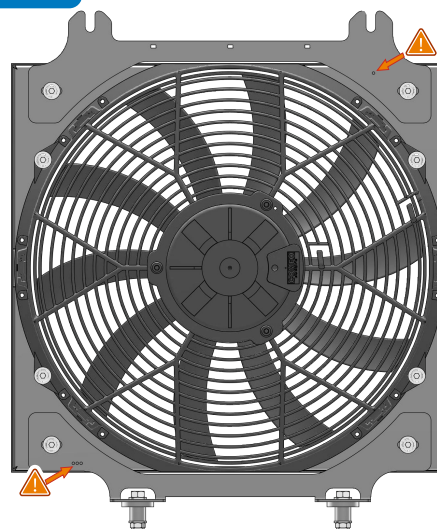

Check the hole pattern position on the brackets matches the image above. Tighten the fixings securing the fan to the shroud, leaving the bracket fixings loose for adjustability. Once the fan kit is fitted to the vehicle, fully tighten all fixings. Ensure the fan blade is free-spinning and that the assembly is not distorted.

STEP 3

Refer to included wiring instructions for next steps.

IMPORTANT NOTES

This Revotec cooling kit has been engineered to provide perfect replacement to the Mazda MX5 cooling fan. However it is essential that the other components in the cooling system are operating correctly. The following must be checked:

1. The radiator has a normal life expectancy of approximately 8-9 years, after this time it should be thoroughly assessed and any signs of deterioration, such as furring up internally or distortion, a replacement is recommended.
2. The radiator fins must be clear of all debris such as mud and leaves.
3. The system must be filled with the correct coolant.
4. The water pump and thermostat must be operating correctly.

Installations are to be undertaken by a competent vehicle mechanic. If in doubt, consult a qualified professional. Always work in a safe environment and wear PPE where necessary. Disconnect the vehicle battery before beginning installation. Failure to comply with the above may result in your warranty being void.